

COALBROOK

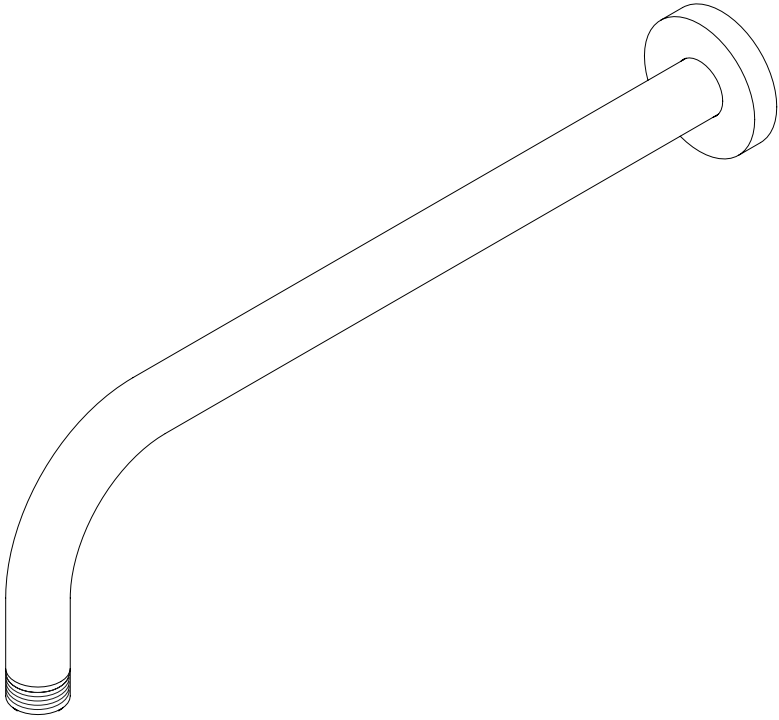

WALL PROJECTION ARM INSTALLATION

CO4006

PROJECTION ARM INSTALLATION DIAGRAM (STEPS 1 - 2)

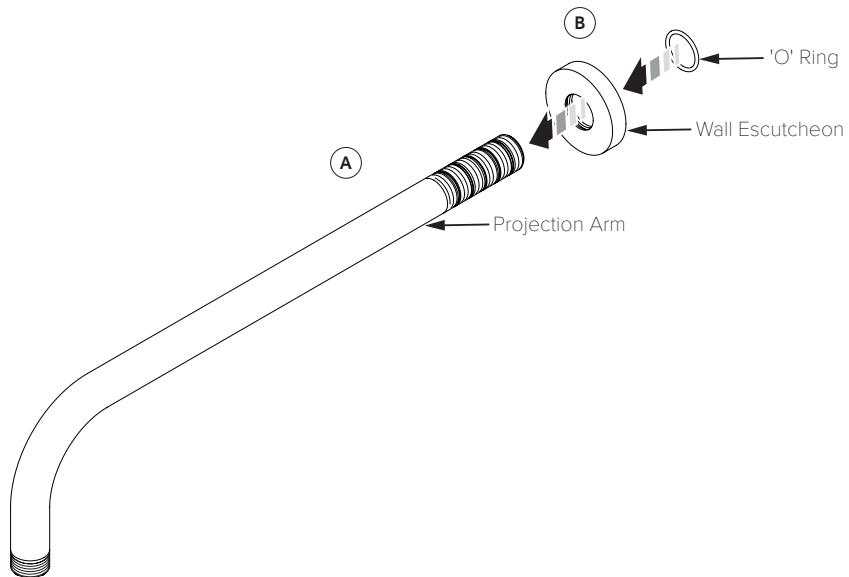

COALBROOK

www.coalbrookuk.co.uk | info@coalbrookuk.co.uk

PROJECTION ARM INSTALLATION INSTRUCTIONS (STEPS 1 - 2)

1. Where required, drill a suitable size hole in the mounting surface to suit the threaded tail on the projection arm (A) which is $\text{Ø}21$.
2. Before installing the projection arm into the wall, slide the wall escutcheon (B) along the projection arm, ensuring that the 'O' ring is assembled in the groove within the escutcheon.

COALBROOK

www.coalbrookuk.co.uk | info@coalbrookuk.co.uk

PROJECTION ARM INSTALLATION DIAGRAM (STEPS 3 - 6)

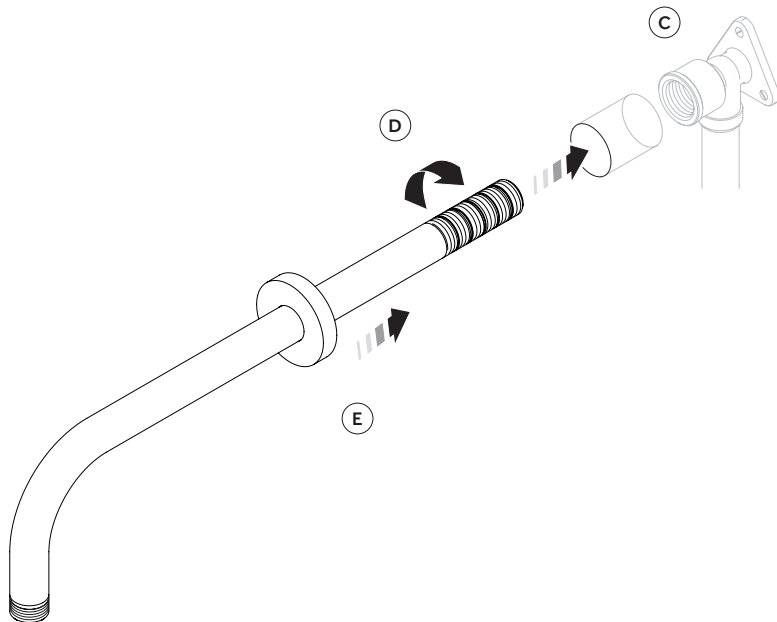

COALBROOK

www.coalbrookuk.co.uk | info@coalbrookuk.co.uk

PROJECTION ARM INSTALLATION INSTRUCTIONS (STEPS 3 - 6)

3. The shower projection arm requires a 1/2" BSP wall outlet recessed in place (C).
4. Measure the depth required for the wall plate to finish flush with the mating wall surface. Cut the threaded tail to the required length.
5. Apply a suitable sealant or sealing tape to the threaded tail. Screw the threaded tail into the female wall outlet (D). Align the projection arm so that the outlet is facing downwards.
6. Slide the wall escutcheon up to the finished wall surface (E), apply a suitable sealant if necessary.

COALBROOK

www.coalbrookuk.co.uk | info@coalbrookuk.co.uk

PROJECTION ARM INSTALLATION DIAGRAM (STEP 7)

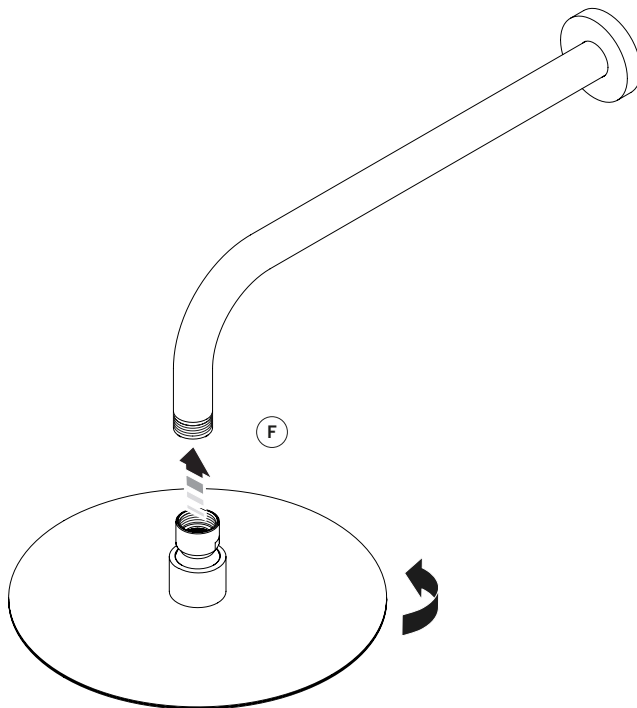

7. Flush all pipework and check for leaks before screwing the shower head onto the threaded end of the projection arm (F).

COALBROOK

www.coalbrookuk.co.uk | info@coalbrookuk.co.uk

SPECIFICATION DIAGRAM (mm)

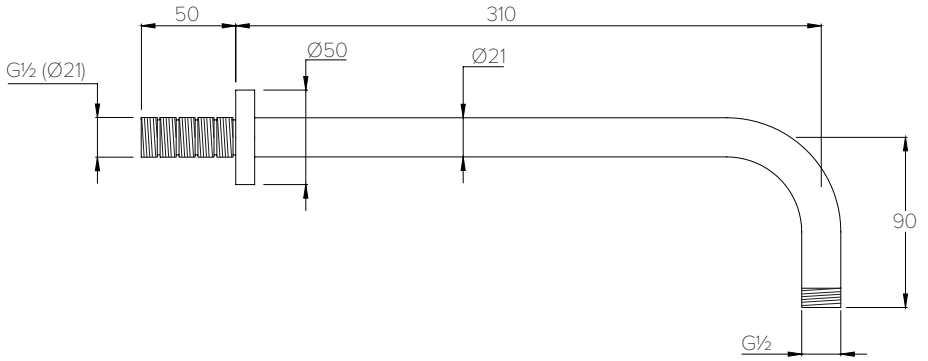

COALBROOK

www.coalbrookuk.co.uk | info@coalbrookuk.co.uk



COALBROOK

Whilst every effort is made to ensure the accuracy of these, they are subject to change without notice as part of the company's product development process. The use of trademarks, product design and artwork is subject to licence or agreement. The design registrations, trademark registrations and copyrights are protected by law and the use or reproduction outside the terms of an agreement is prohibited.

The right to modify designs and dimensions is reserved. E & O.E.

COALBROOK

www.coalbrookuk.co.uk | info@coalbrookuk.co.uk